

# Cobbs Creek Wetlands Restoration Project at Lankenau Hospital

Presentation of Design Concept to  
Delaware Estuary Conference

January 24, 2007

Gwyn Rowland, Director, Water Resources  
Programs

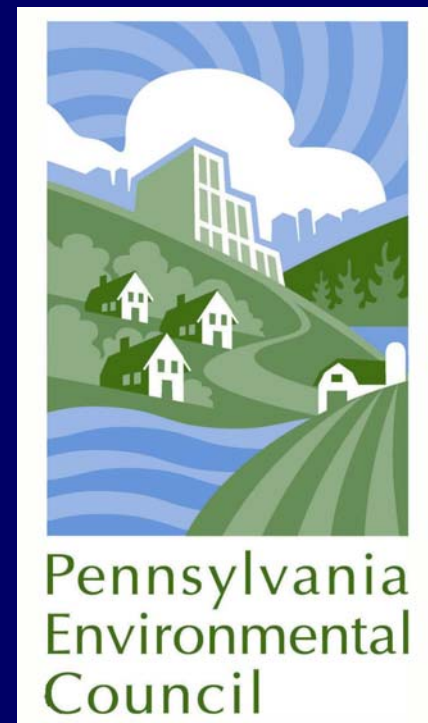

# SE Pennsylvania Watershed Map

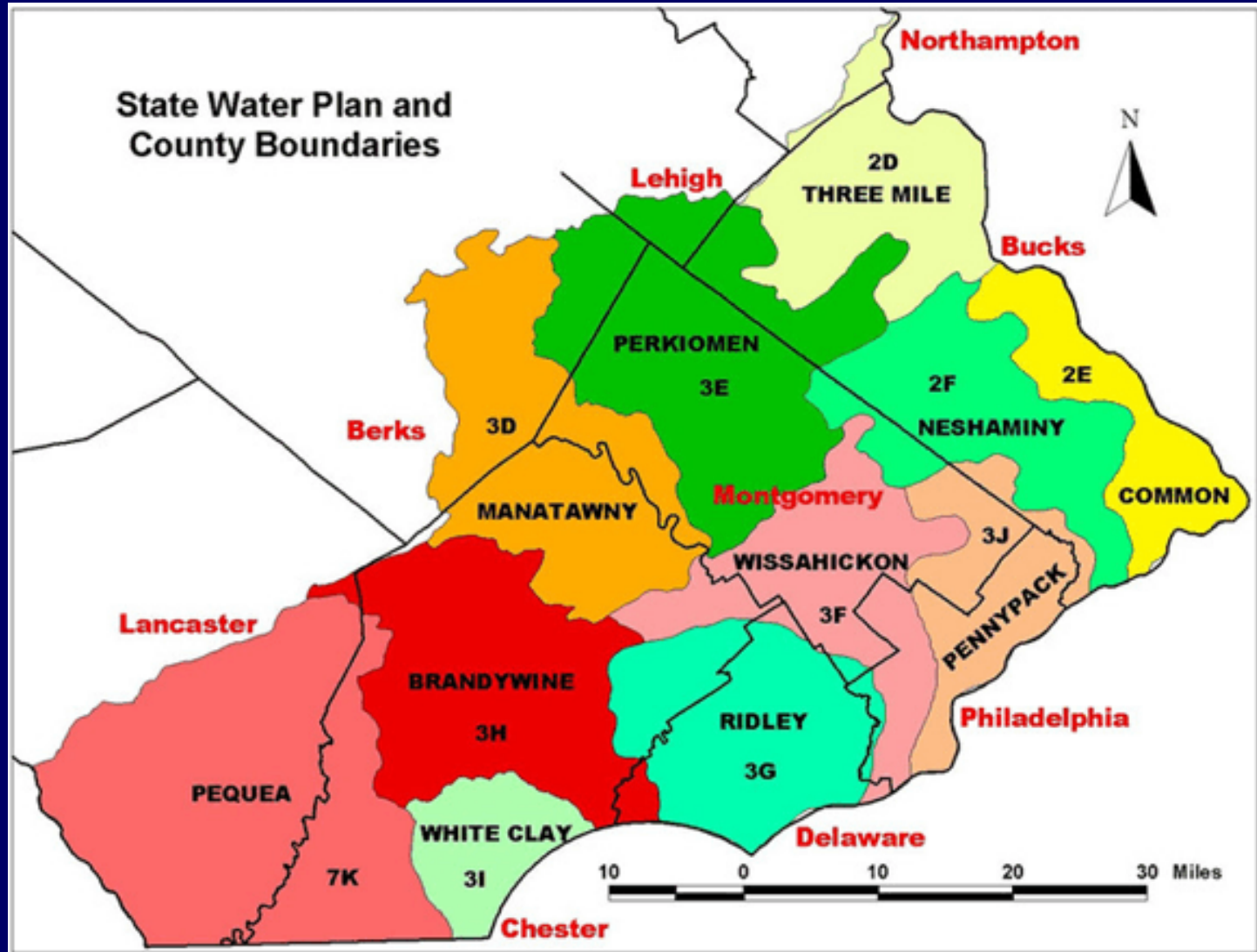

# Wetland Restoration Site



# Wetland Restoration Site



# Wetland Restoration Site



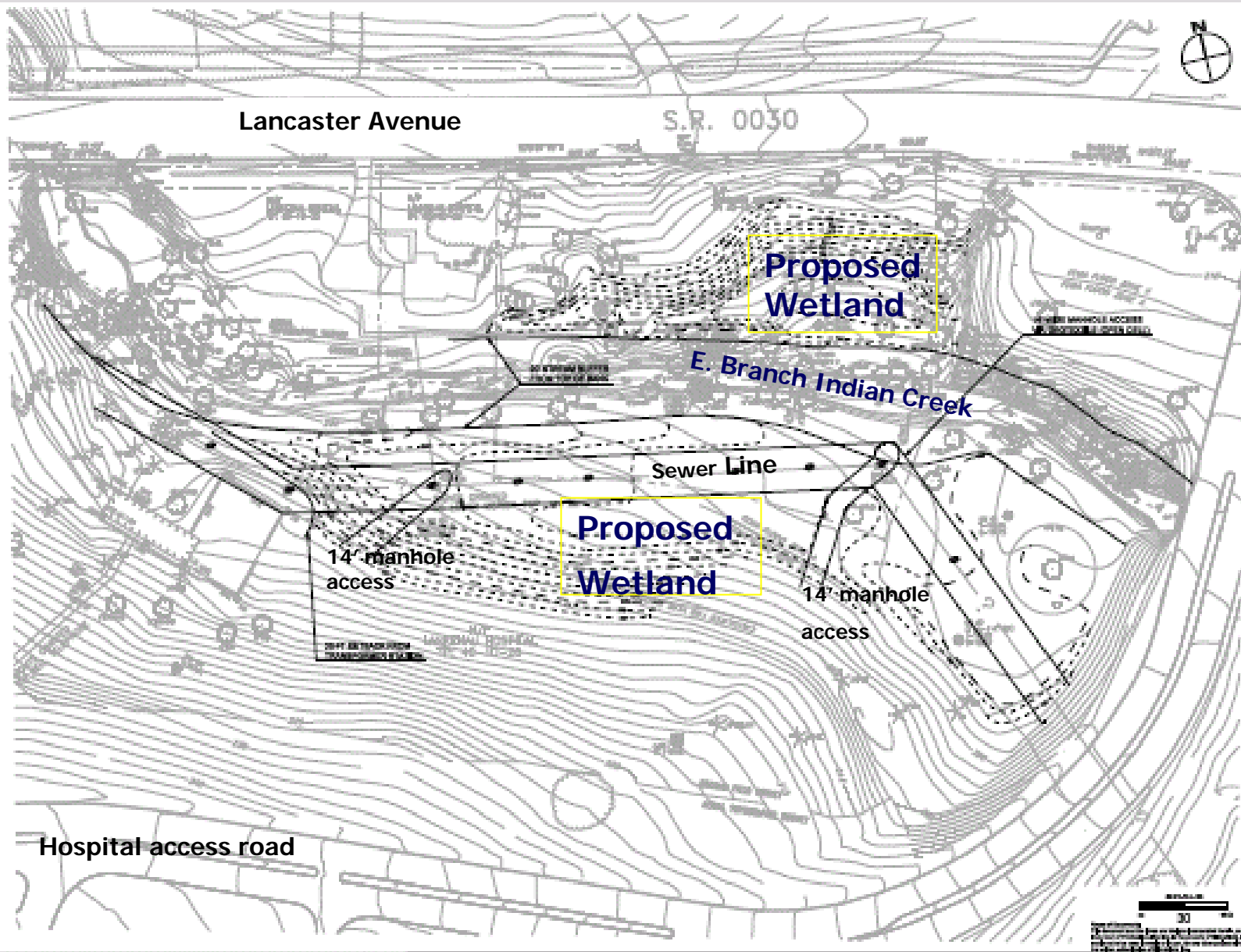

LANKENAU HOSPITAL  
WETLAND RESTORATION -  
WEST INDIAN  
BRANCH FLOODPLAIN

LOWER MERION TOWNSHIP  
MONTGOMERY COUNTY, PA

Project No. 2010-001	Scale: 1" = 40'
Client: Lankenau Hospital	Design: [Signature]
Contract: [Number]	Date: [Date]

LANKENAU  
HOSPITAL  
WETLAND  
RESTORATION

Sheet No. [Number]  
Project No. [Number]

GRADING PLAN	
DATE	SCALE
1 OF 2	

## Grading Plan

- Generally mimic existing land on south side of creek
- Increase excavation required on north side
- Design provides for 20 ft buffer from top of stream bank
- Provides driving access to Sewer Easement / manholes for inspection & maintenance

# Project Overview



Pennsylvania  
Environmental  
Council

- Project Impetus: Darby-Cobbs Integrated Watershed Management Plan.
- Performed site analysis and feasibility study of five potential wetland restoration sites in the Cobbs Creek Watershed.

# Site Selection

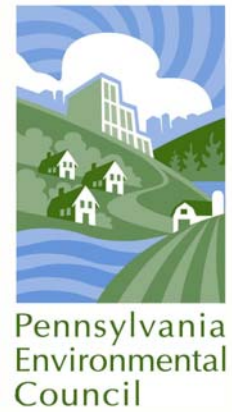

- Site at Lanckenau was chosen because of existing natural features including existing soils and hydrology. Existing vegetation will be modified to allow for wetland establishment.
- Current and future planned uses by the landowner allow for wetland restoration.
- Property owner willingness was high.
- Community interest in the project and civic response was positive.

# Site Limitations

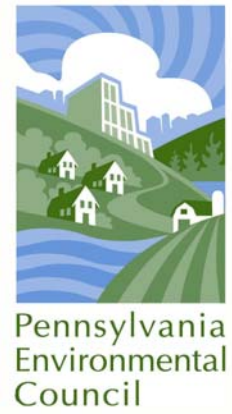

- Main sewer line of township runs parallel to the creek.
- The Township required the construction of an access road. This request has translated into a 14 foot wide road bed to allow vehicle access and maneuverability being added into the plan.
- The Township required three feet of cover over the sewer main to ensure its protection and integrity.
- Hospital will be constructing an additional roadway to the hospital.

# Next Steps

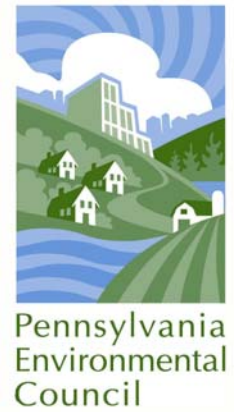

- Concept design complete.
- Funding from National Fish and Wildlife Foundation and Growing Greener 2 secured.
- Building partnership with US Fish and Wildlife Service, Natural Resource Conservation Service for wetland construction.
- Invasive plant control
- Enlist support from hospital and community partners as "caretakers"
- Conservation easement -- an option for protecting the wetland in perpetuity

# Functions and Values

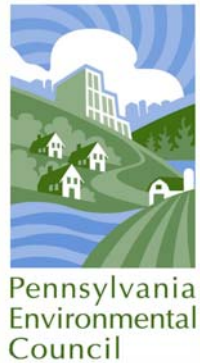

- Enhances native habitat in Cobbs Creek Watershed
- Increases riparian buffer along E. Branch Indian Creek... improves water quality and helps control stormwater runoff
- Controls some stormwater runoff from hospital
- Positive drainage (i.e., drains toward creek and toward bridge)
- Temporarily inundated after rain
- Designed to drain within 72 hrs. after storms
- Seasonally to permanently saturated (dependent upon weather)
- Potential Nature Trail ... educate community and provide hospital staff and patients with natural setting.

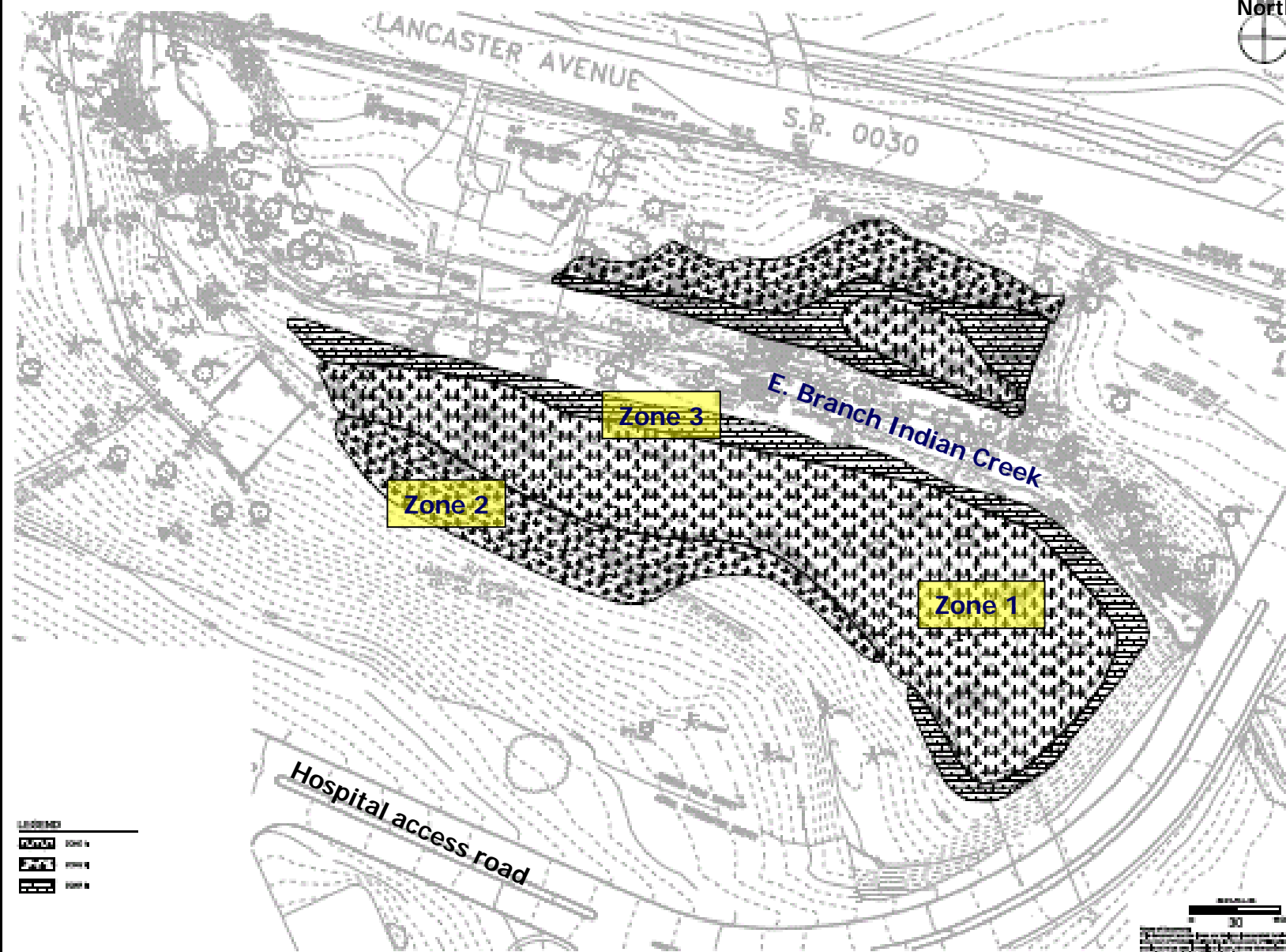

North

LANCKENAUA HOSPITAL  
WETLAND RESTORATION -  
WEST INDIAN  
BRANCH FLOODPLAIN

LOWER MERION TOWNSHIP  
MONTGOMERY COUNTY, PA

---

Approved by the Montgomery County  
and Chester County Planning  
Agencies

Prepared by:  
The Planning Commission  
of Montgomery County, PA

---

LANCKENAUA  
HOSPITAL  
WETLAND  
RESTORATION

Scale 1" = 30'

**PLANTING PLAN**

DATE	NO.	DESCRIPTION

2 OF 2

# Planting Plan

Zone 1 : Flowering Perennials and Shrubs - "Wet Meadow"

Zone 2 : Upland Woods

Zone 3 : Riparian Woods

Cardinal  
Flower



© William S. Justice



Turtlehead



Lobelia

Blue Flag



Blue Flag Iris



Black-Eyed Susan

Flowering  
Perennials



Sycamore



Red Maple



**Native Trees  
and Shrubs**

# Questions?

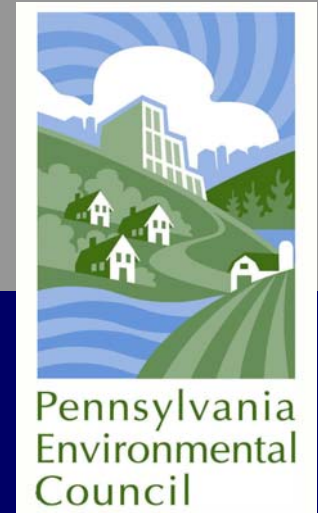

Generously funded and supported by  
**National Fish and Wildlife Foundation,**  
William Penn Foundation, and  
Philadelphia Water Department (Office of Watersheds)

[www.pecpa.org](http://www.pecpa.org)